

RIQUALIFICAZIONE PIAZZA ROMA A SOAVE

Progetto Preliminare - I Stralcio - Elaborati Grafici

progettista: architetto Rosanna Moffa
collaboratori: geometra Elena Bombana



Porto Mantovano 10 dicembre 2013

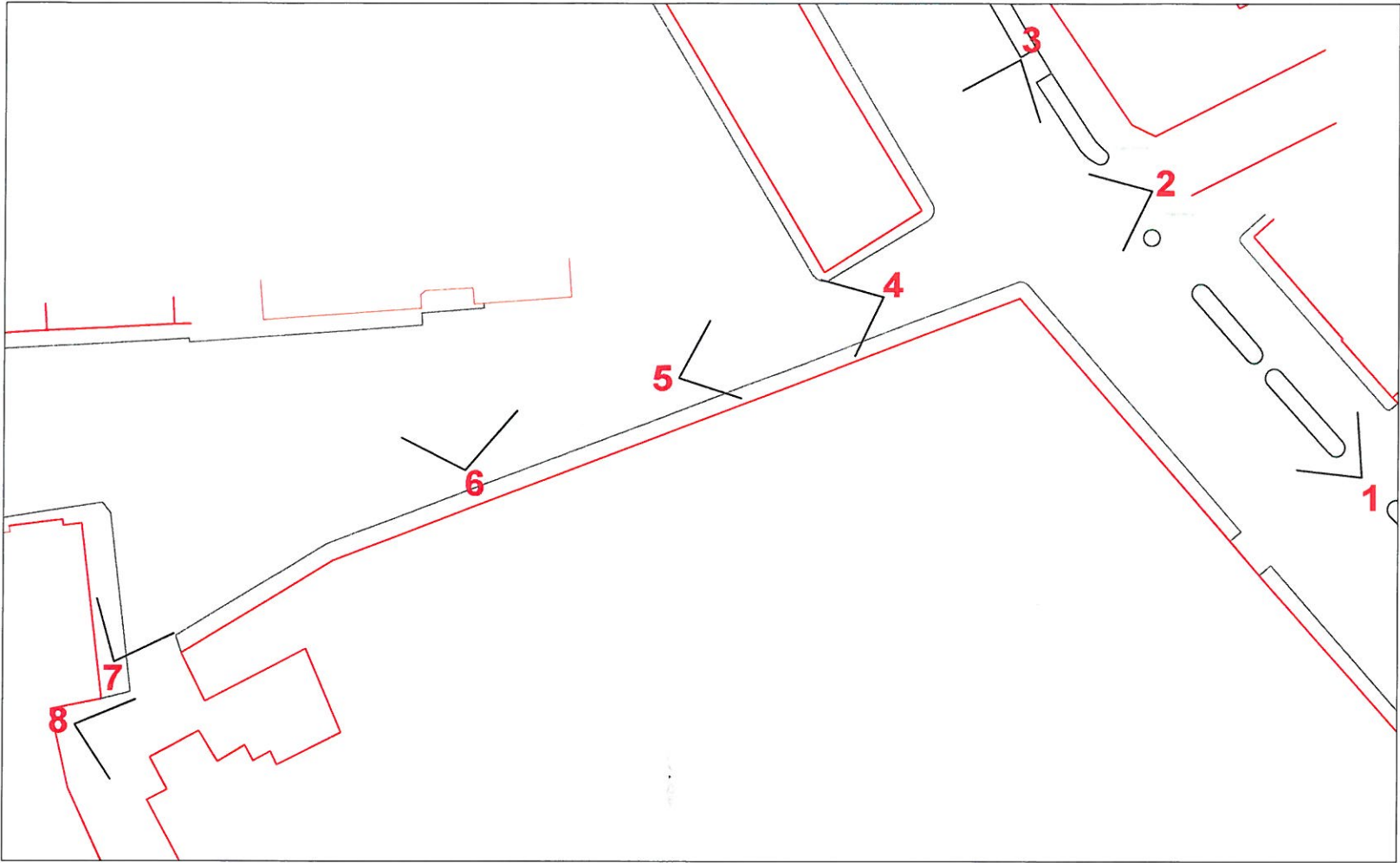

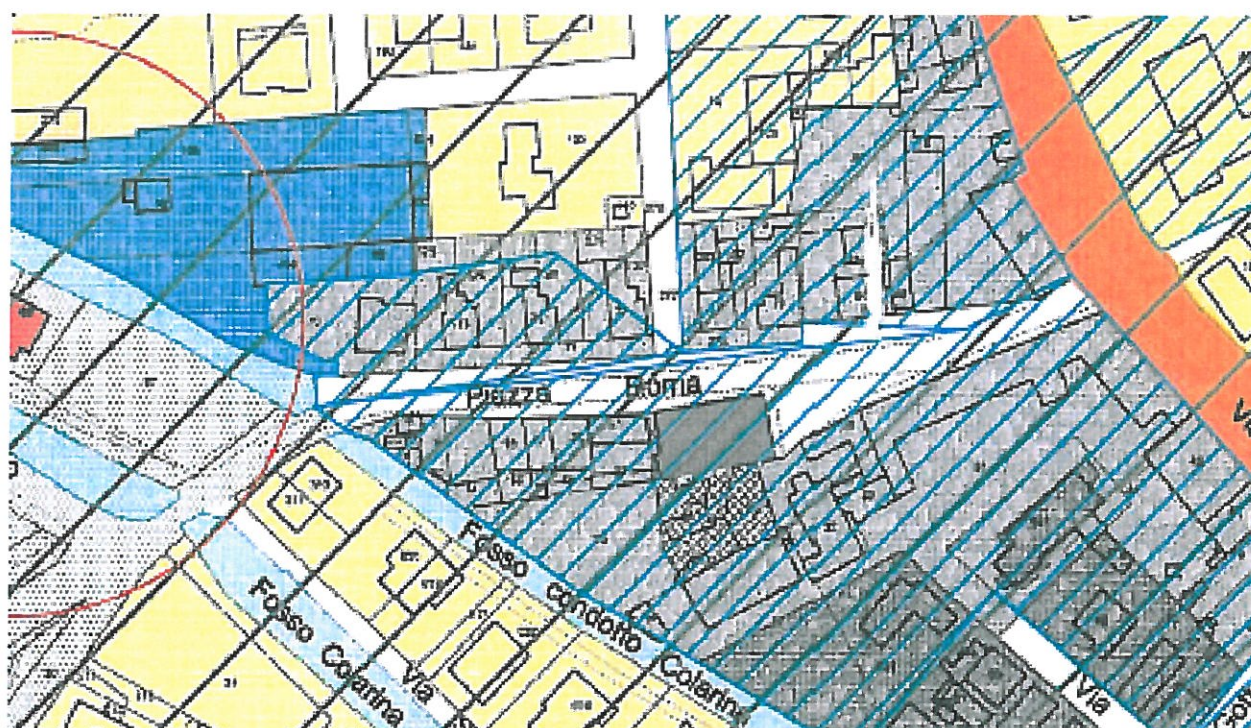

ESTRATTO DI P.G.T. VIGENTE SCALA 1:2000

- | | | | |
|---|--|---|------------------------------|
|  | AMBITO CENTRO STORICO |  | NUCLEI DI VECCHIA FORMAZIONE |
|  | BENI STORICO-ARCHITETTONICI IN AMBITO URBANO | | |
|  | BENI STORICO-ARCHITETTONICI IN AMBITO AGRICOLO | | |



ESTRATTO DI P.T.C. del PARCO DEL MINCIO

SCALA 1:10.000

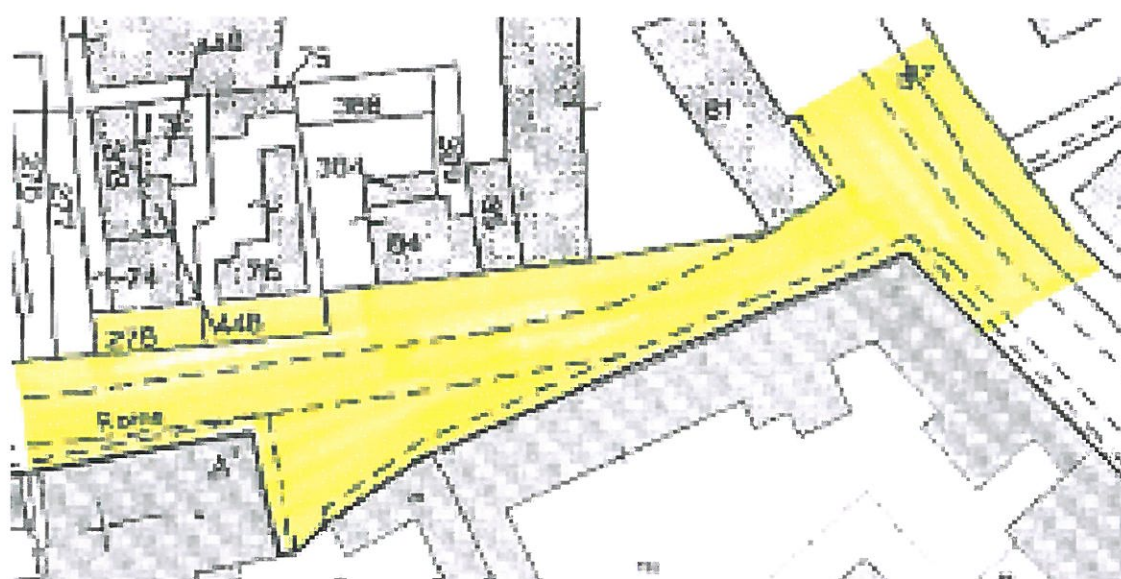

ESTRATTO CATASTALE SCALA 1:1000

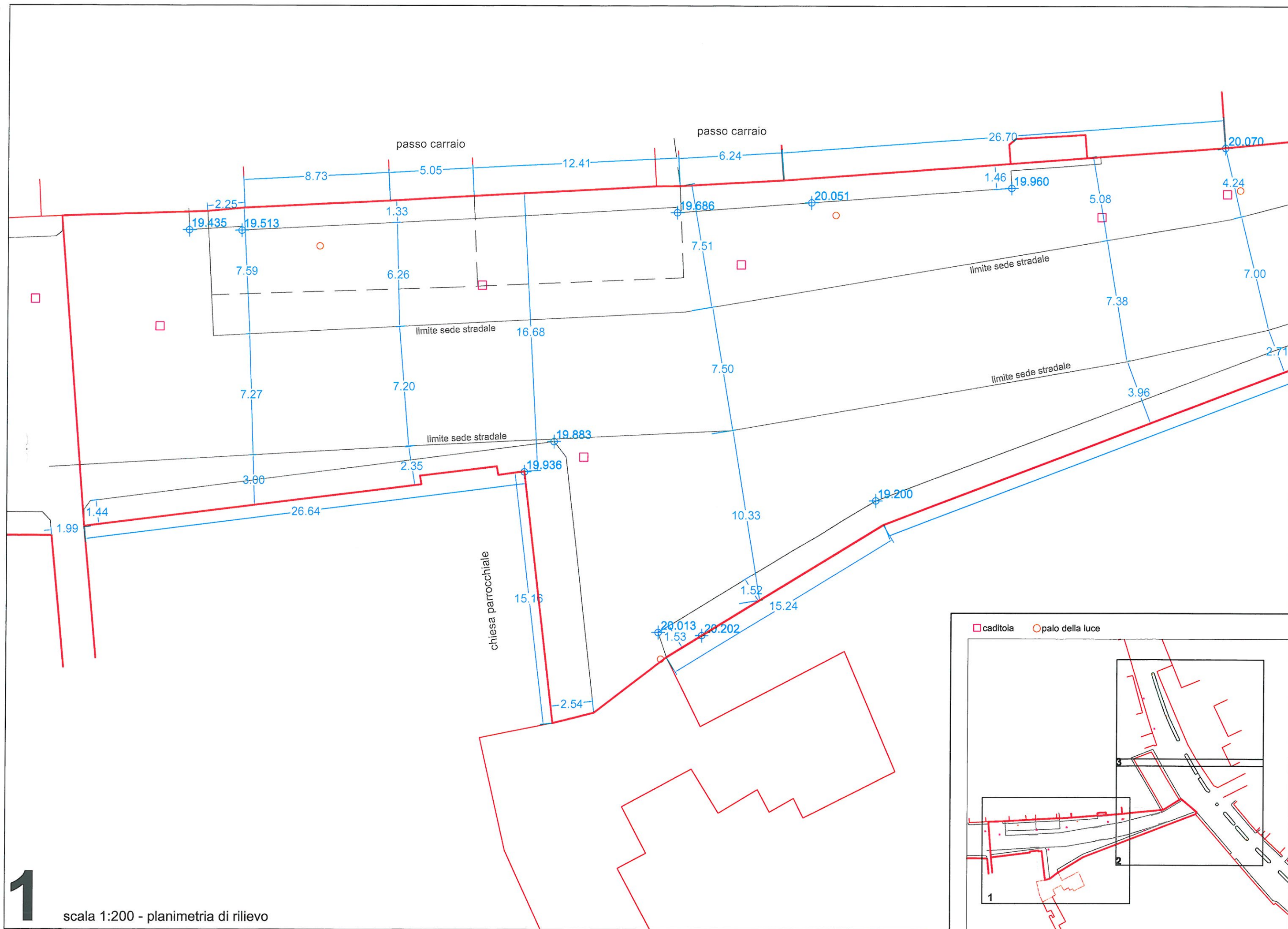

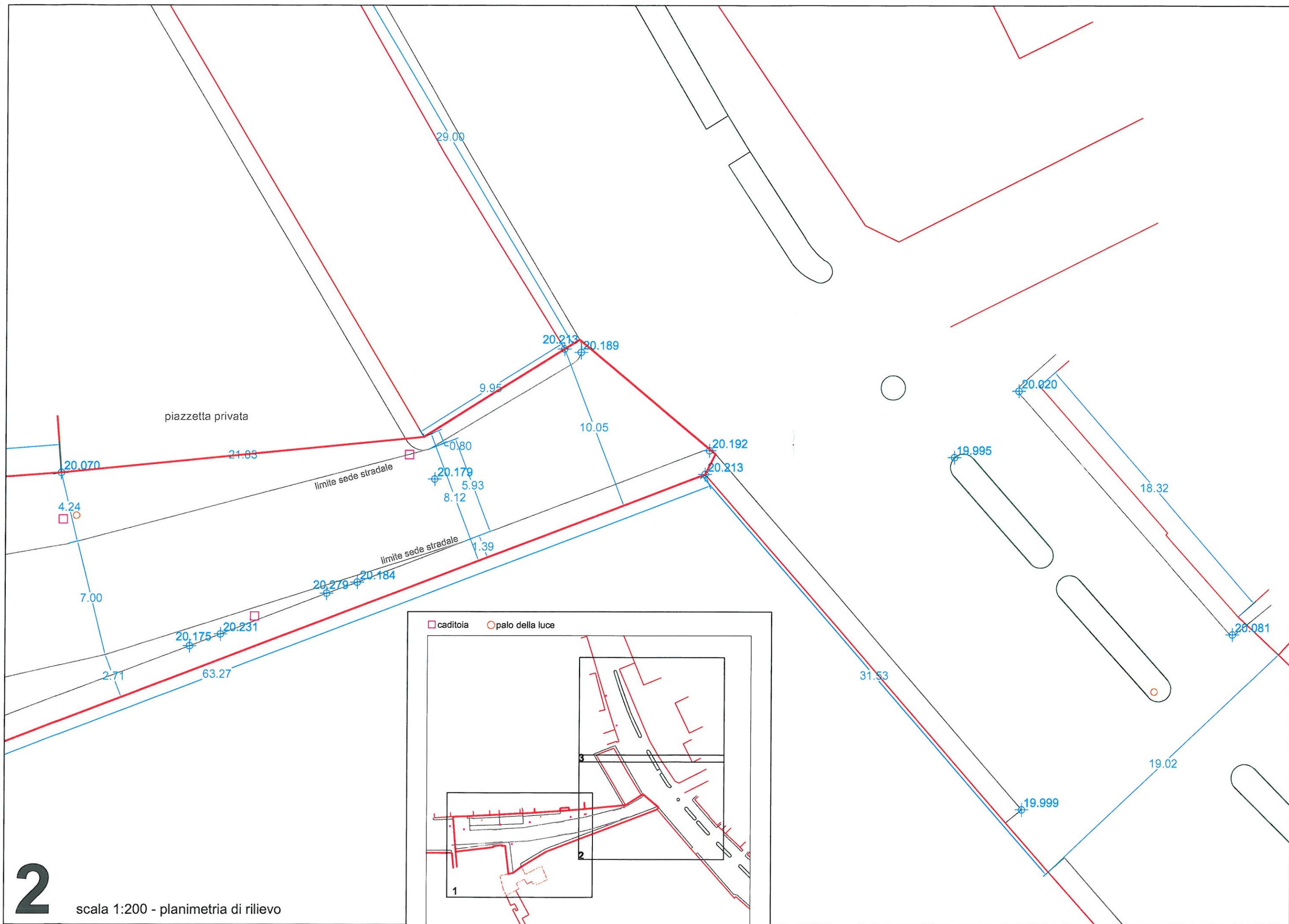

2

scala 1:200 - planimetria di rilievo

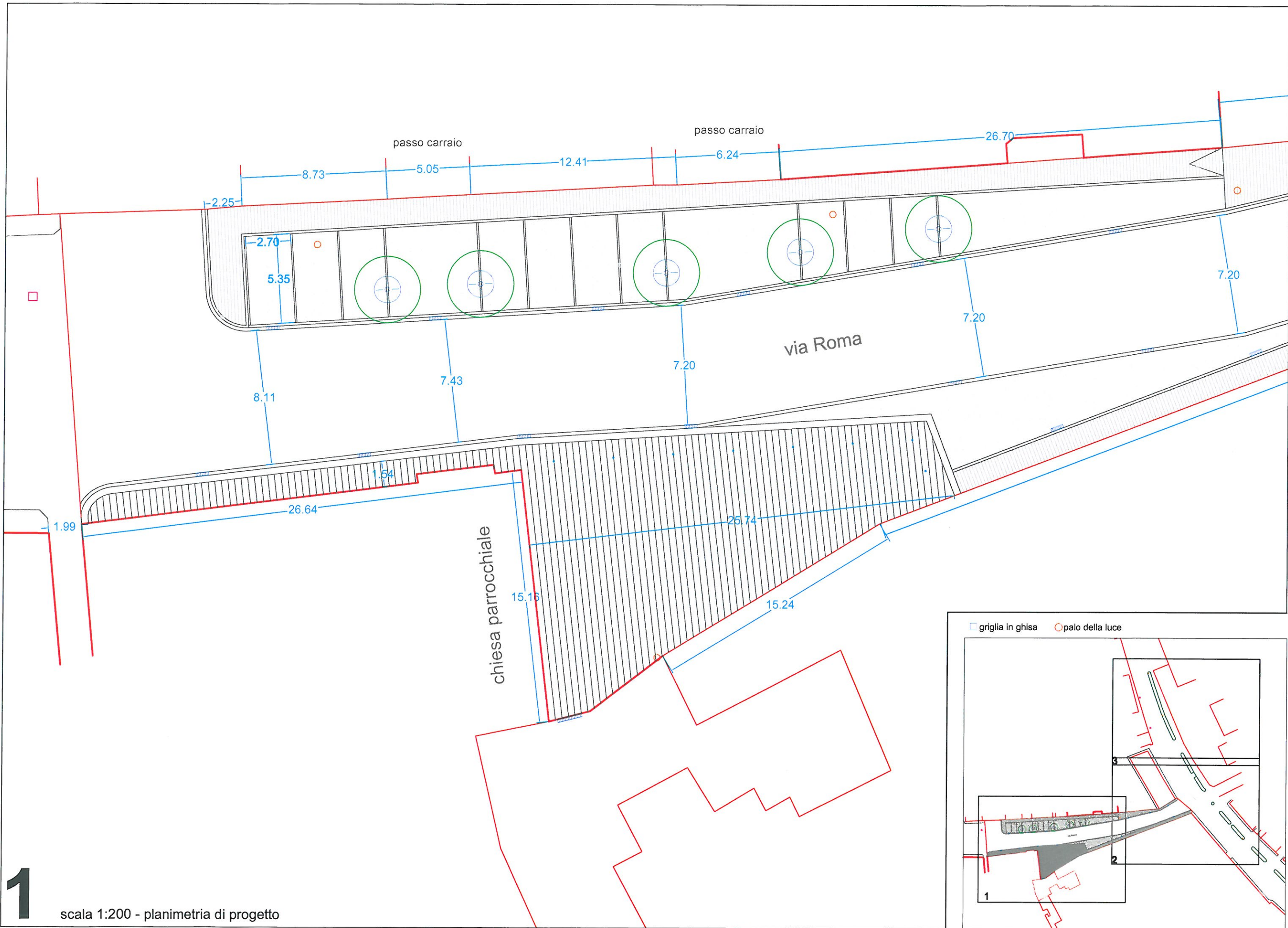

1

scala 1:200 - planimetria di progetto

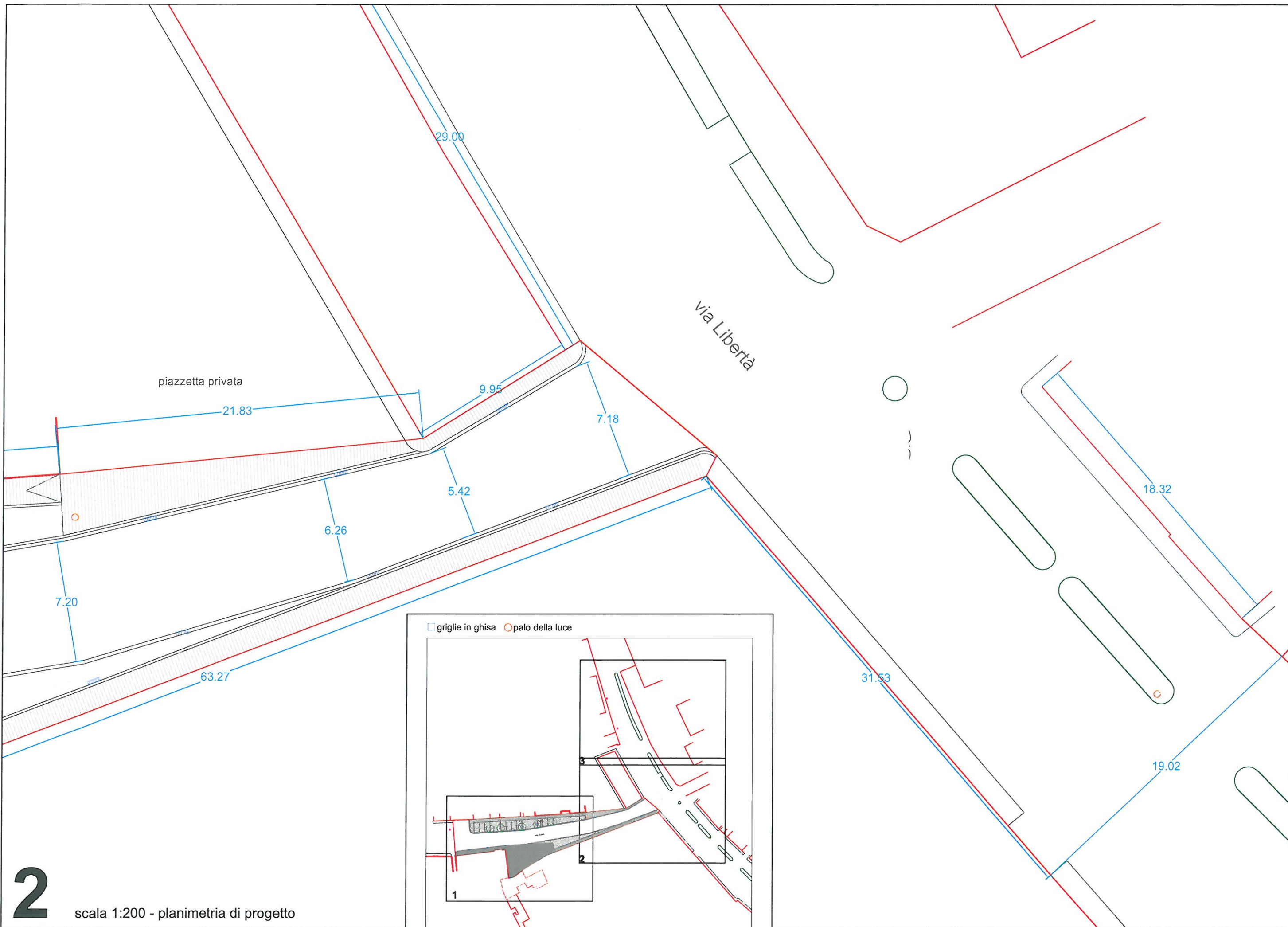

2

scala 1:200 - planimetria di progetto